

# FOR LEASE AIRPORT 295 LOGISTICS PARK

12435 LEM TURNER ROAD | JACKSONVILLE, FL 32218



## UP TO 500,000 SF AVAILABLE FOR LEASE NEW STATE-OF-THE-ART INDUSTRIAL PARK

- Three new warehouses
- Premier location in North Florida
- Immediate highway access with close proximity to Jacksonville International Airport and JAXPORT
- Seasoned Developer/Owner with proven national track record of industrial development
- Various space sizes available
- Single/Multi-Tenant building configurations available
- Multiple points of ingress and egress
- Visible from I-295
- ± 55 million consumers within an 8 hour drive time

LAND SIZE

**±42 Acres**

DELIVERY DATE

**Q3 2024**



On-site Trailer Parking



Class A Built-to-Suit office



32-FT Clear Height (Bldg 100 & 200)



Secure with the ability to privatize truck courts



36- FT Clear Height (Building 300)



Rear Load configurations



441 Auto Parking Spaces

### Contact Info

**JACOB HORSLEY**  
Executive Managing Director  
jacob.horsley@cushwake.com  
+1 904 380 8335

**TYLER NEWMAN**  
Executive Managing Director  
tyler.newman@cushwake.com  
+1 904 380 8336

LEASED BY:



DEVELOPED BY:



# AIRPORT 295 LOGISTICS PARK SITE PLAN

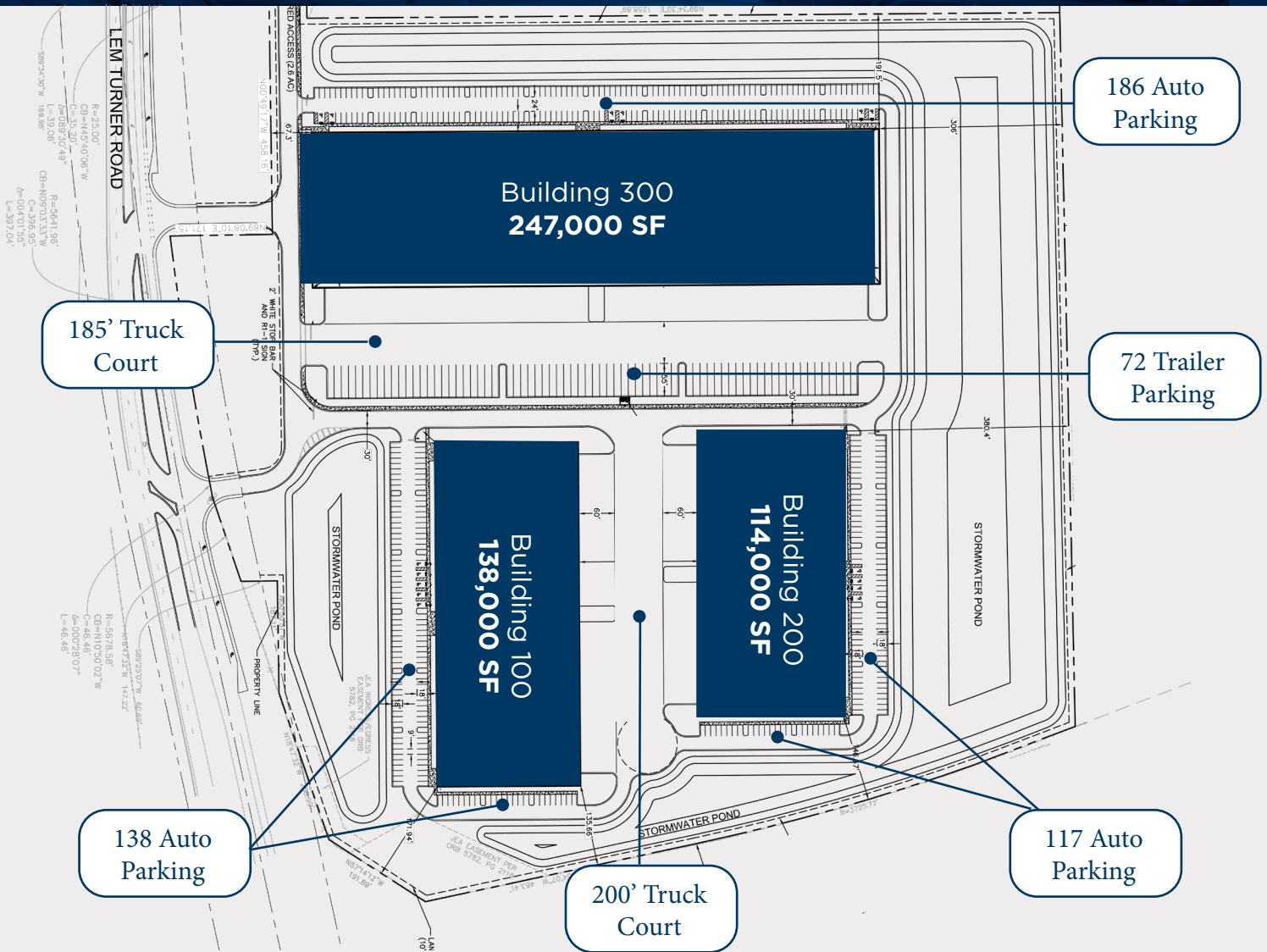

## BUILDING FEATURES

### BUILDING 100

- 138,000 SF
- 240' Building depth
- 32' Clear height
- 30 Dock / 2 Drive-in
- 138 Parking spaces
- 200' Truck court (shared)

### BUILDING 200

- 114,000 SF
- 240' Building depth
- 32' Clear height
- 22 Dock / 2 Drive-in
- 117 Parking spaces
- 200' Truck court (shared)

### BUILDING 300

- 247,000 SF
- 260' Building depth
- 36' Clear height
- 56 Dock / 2 Drive-in
- 186 Auto / 72 Trailer Parking
- 185' Truck Court

12435 LEM TURNER ROAD AND  
WEST I-295 BELTWAY

LEASED BY: CUSHMAN & WAKEFIELD

DEVELOPED BY: SEEFRIED

# AIRPORT 295 LOGISTICS PARK LOCATION MAP

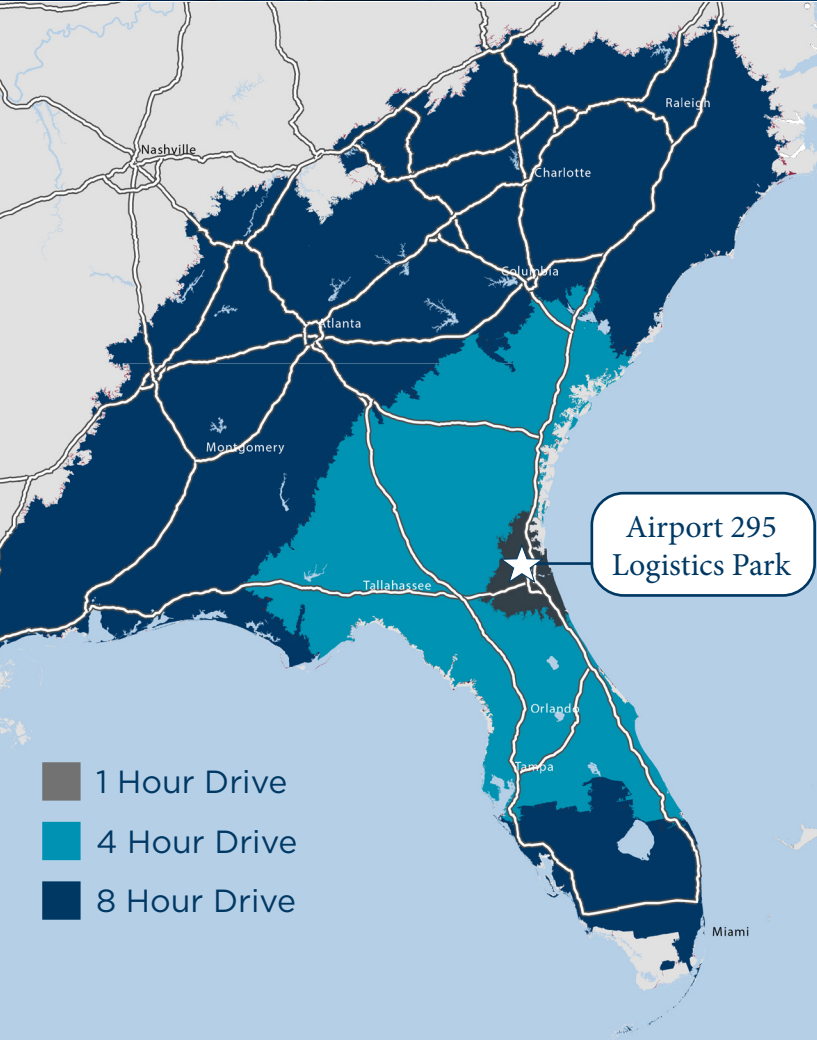

To I-295 <0.2 miles

To I-95 3.6 miles

To I-10 11 Miles

To Airport 5 miles

To JAXPORT Tallyrand 14.6 miles

To JAXPORT Blount Island 12 miles

To Orlando 156 miles

To Savannah 133 Miles

### Contact Info

**JACOB HORSLEY**  
Executive Managing Director  
jacob.horsley@cushwake.com  
+1 904 380 8335

**TYLER NEWMAN**  
Executive Managing Director  
tyler.newman@cushwake.com  
+1 904 380 8336

LEASED BY:



DEVELOPED BY:



©2023 Cushman & Wakefield. All rights reserved. The information contained in this communication is strictly confidential. This information has been obtained from sources believed to be reliable but has not been verified. NO WARRANTY OR REPRESENTATION, EXPRESS OR IMPLIED, IS MADE AS TO THE CONDITION OF THE PROPERTY (OR PROPERTIES) REFERENCED HEREIN OR AS TO THE ACCURACY OR COMPLETENESS OF THE INFORMATION CONTAINED HEREIN, AND SAME IS SUBMITTED SUBJECT TO ERRORS, OMISSIONS, CHANGE OF PRICE, RENTAL OR OTHER CONDITIONS, WITHDRAWAL WITHOUT NOTICE, AND TO ANY SPECIAL LISTING CONDITIONS IMPOSED BY THE PROPERTY OWNER(S). ANY PROJECTIONS, OPINIONS OR ESTIMATES ARE SUBJECT TO UNCERTAINTY AND DO NOT SIGNIFY CURRENT OR FUTURE PROPERTY PERFORMANCE.